



ST

SERIES

ST Connector

Product Specifications

General Data

Number of Positions	3/4/6/12P
Contact Housing	Nylon + GF
Terminal	Copper Alloy, Gold Plated

Electrical Data

Current Rating	13A
Voltage Rating	250V DC
Insulation Resistance	≥ 1000MΩ at DC 500V
Withstanding Voltage	AC 1000V/1 Minute
Standard	-

Environmental Data

Mating Style	Snap Type
Temperature Range	-55°C ~ +125°C
Salt Spray	96 hr.
Protection Class	IPX8 (Mated)
Durability	100 Times

How to Order

STXX - XX X X - XXXX

Style
04 - Receptacle
06 - Plug

Number of Contacts
03, 04, 06, 12

Key
Blank - No Key
A - A Key
B - B Key
C - C Key
D - D Key

Special Modifications
E004 - Black Body
EP07 - Black Body + Enhanced Seal Retention
P012 - Black Body + Enhanced Seal Retention

Contact Type
P - Pin
S - Socket

Pin Arrangement

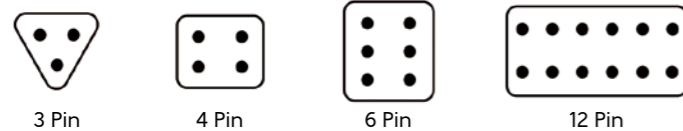

ST Connector Cable Assembly Straight, IPX8 (Mated)

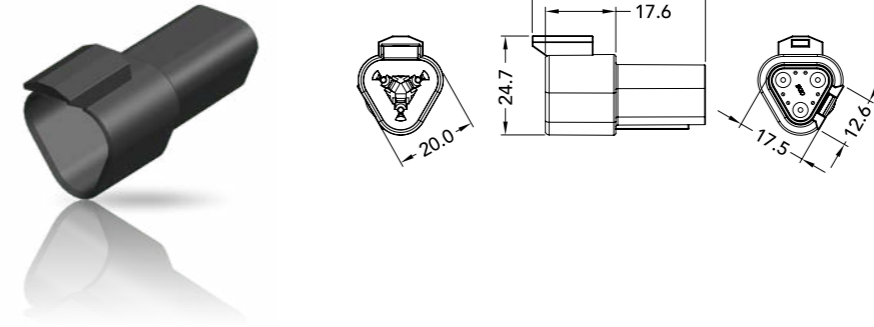

Features and Benefits

- Compatible with existing connectors
- High performance
- Easy to use with snap mating type
- Rugged design for applications in harsh environments

Part Number	Contact	Current	Voltage	Color
ST04-3P-E004	3PIN	13A	250V	Black

Mating Part: ST06-3S-E004 (See page J-5)
 ST Wedglock: SW3P (See page J-7)
 ST Terminal: S0460-202-16141, S0460-215-16141, S1060-16-0622, S1060-16-0122 (See page J-8, 9)
 ST Sealing Plug: S114017 (See page J-10)

ST Connector Cable Assembly Straight, IPX8 (Mated)

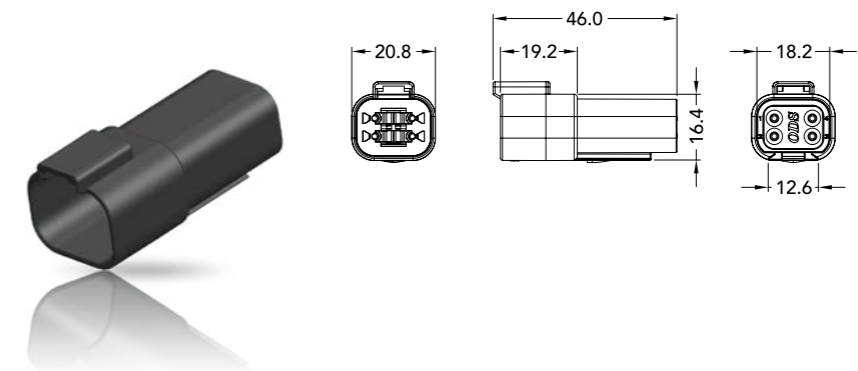

Features and Benefits

- Compatible with existing connectors
- High performance
- Easy to use with snap mating type
- Rugged design for applications in harsh environments

Part Number	Contact	Current	Voltage	Color
ST04-4P-E004	4PIN	13A	250V	Black

Mating Part: ST06-4S-E004 (See page J-5)
 ST Wedglock: SW4P (See page J-7)
 ST Terminal: S0460-202-16141, S0460-215-16141, S1060-16-0622, S1060-16-0122 (See page J-8, 9)
 ST Sealing Plug: S114017 (See page J-10)

ST Connector Cable Assembly Straight, IPX8 (Mated)

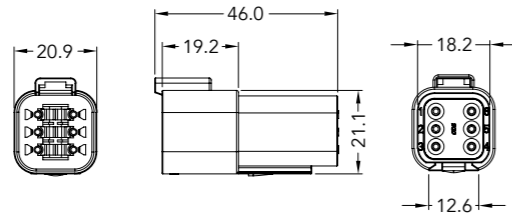

Features and Benefits

- Compatible with existing connectors
- High performance
- Easy to use with snap mating type
- Rugged design for applications in harsh environments

Part Number	Contact	Current	Voltage	Color
ST04-6P-E004	6PIN	13A	250V	Black

Mating Part: ST06-6S-P012 (See page J-6)

ST Wedglock: SW6P (See page J-7)

ST Terminal: S0460-202-16141, S0460-215-16141, S1060-16-0622, S1060-16-0122 (See page J-8, 9)

ST Sealing Plug: S114017 (See page J-10)

ST Connector Cable Assembly Straight, IPX8 (Mated)

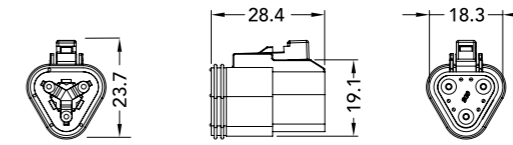

Features and Benefits

- Compatible with existing connectors
- High performance
- Easy to use with snap mating type
- Rugged design for applications in harsh environments

Part Number	Contact	Current	Voltage	Color
ST06-3S-E004	3PIN	13A	250V	Black

Mating Part: ST04-3P-E004 (See page J-3)

ST Wedglock: SW3S (See page J-7)

ST Terminal: S0462-201-16141, S0462-209-16141, S1062-16-0622, S1062-16-0122 (See page J-8, 9)

ST Sealing Plug: S114017 (See page J-10)

ST Connector Cable Assembly Straight, IPX8 (Mated)

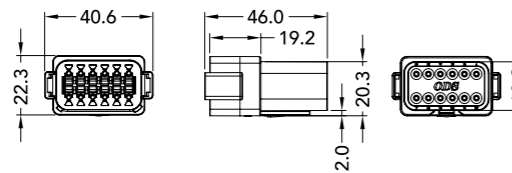

Features and Benefits

- Compatible with existing connectors
- High performance
- Easy to use with snap mating type
- Rugged design for applications in harsh environments

Part Number	Contact	Current	Voltage	Color
ST04-12PA-E004	12PIN	13A	250V	Black

Mating Part: ST06-12SA-EP07 (See page J-6)

ST Wedglock: SW12P (See page J-7)

ST Terminal: S0460-202-16141, S0460-215-16141, S1060-16-0622, S1060-16-0122 (See page J-8, 9)

ST Sealing Plug: S114017 (See page J-10)

ST Connector Cable Assembly Straight, IPX8 (Mated)

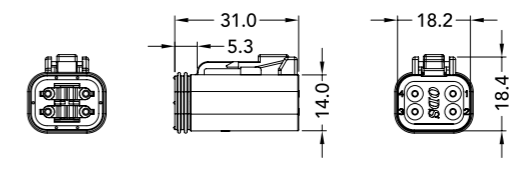

Features and Benefits

- Compatible with existing connectors
- High performance
- Easy to use with snap mating type
- Rugged design for applications in harsh environments

Part Number	Contact	Current	Voltage	Color
ST06-4S-E004	4PIN	13A	250V	Black

Mating Part: ST04-4P-E004 (See page J-3)

ST Wedglock: SW4S (See page J-7)

ST Terminal: S0462-201-16141, S0462-209-16141, S1062-16-0622, S1062-16-0122 (See page J-8, 9)

ST Sealing Plug: S114017 (See page J-10)

ST Connector Cable Assembly Straight, IPX8 (Mated)

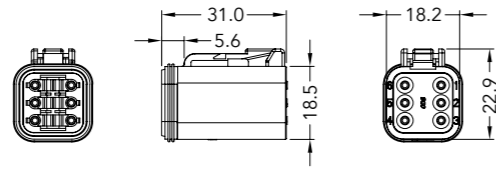

Features and Benefits

- Compatible with existing connectors
- High performance
- Easy to use with snap mating type
- Rugged design for applications in harsh environments

Part Number	Contact	Current	Voltage	Color
ST06-6S-P012	6PIN	13A	250V	Black

Mating Part: ST04-6P-E004 (See page J-4)

ST Wedgelock: SW6S (See page J-7)

ST Terminal: S0462-201-16141, S1062-16-0622, S0462-209-16141, S1062-16-0122 (See page J-8, 9)

ST Sealing Plug: S114017 (See page J-10)

ST Connector Cable Assembly Straight, IPX8 (Mated)

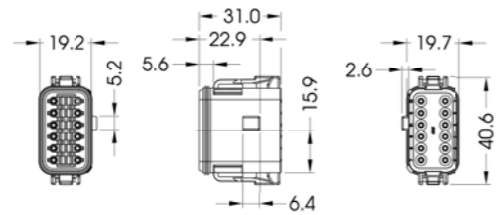

Features and Benefits

- Compatible with existing connectors
- High performance
- Easy to use with snap mating type
- Rugged design for applications in harsh environments

Part Number	Contact	Current	Voltage	Color
ST06-12SA-EP07	12PIN	13A	250V	Black

Mating Part: ST04-12PA-E004 (See page J-4)

ST Wedgelock: SW12S (See page J-7)

ST Terminal: S0462-201-16141, S0462-209-16141, S1062-16-0622, S1062-16-0122 (See page J-8, 9)

ST Sealing Plug: S114017 (See page J-10)



ST Wedgelock

Features and Benefits





- Compatible with existing connectors
- High performance
- Rugged design for applications in harsh environments

	Part Number	Contact	Material	Color
	SW3P	3PIN	Plastic	Black
	SW4P	4PIN	Plastic	Black
	SW6P	6PIN	Plastic	Black
	SW12P	12PIN	Plastic	Black
	SW3S	3PIN	Plastic	Black
	SW4S	4PIN	Plastic	Black
	SW6S	6PIN	Plastic	Black
	SW12S	12PIN	Plastic	Black



ST Terminal

	Part Number	Connector Gender	Material	Cable Range	Color
	S0462-201-16141	Female	Metal	16AWG-20AWG	Nickel Plated
	S0460-202-16141	Male	Metal	16AWG-20AWG	Nickel Plated
	S0462-209-16141	Female	Metal	14AWG	Nickel Plated
	S0460-215-16141	Male	Metal	14AWG	Nickel Plated





ST Terminal

	Part Number	Connector Gender	Material	Cable Range	Color
	S1062-16-0622	Female	Metal	16AWG-20AWG	Nickel Plated
	S1060-16-0622	Male	Metal	16AWG-20AWG	Nickel Plated
	S1062-16-0122	Female	Metal	14AWG-18AWG	Nickel Plated
	S1060-16-0122	Male	Metal	14AWG-18AWG	Nickel Plated

ST Sealing Plug

Part Number	Connector Gender	Material	Cable Range	Color
 S114017	N/A	Plastic	14AWG-20AWG	White

ST Hand Tools

Part Number	Contact Size	Contacts Part Number	Description
 SDT-RT1	-	-	Tool for wedglock removal and contact release
 SDTT-16-00 (14-16 AWG)	16	S1060-16-0122 S1062-16-0122	Tools for stamped and formed contacts
 SDTT-16-01 (18 AWG)	16	S1060-16-0622 S1062-16-0622	Tools for stamped and formed contacts
 SHDT-48-00	16	S0460-202-16141 S0462-201-16141 S0460-215-16141 S0462-209-16141	Tools for solid conatct Four ident crimp

